

# SPECIFICATION



588

LOA		17.20 m	56' 5"
Hull length		16.70 m	54' 9"
LWL		15.15 m	49' 8"
Beam		5.20 m	17' 1"
Draft			
shallow keel		2.25 m	7' 5"
L-keel, medium		2.60 m	8' 6"
T-keel, deep		2.85 m	9' 4"
Displacement			
shallow keel	approx.	23.00 t	50,706 lbs
L-keel, medium	approx.	22.80 t	50,265 lbs
T-keel, deep	approx.	22.20 t	48,943 lbs
Engine Diesel			
standard	approx.	110 PS	110 hp
option	approx.	150 PS	150 hp
Fuel tank	approx.	520 l	137 gal
Fresh water	approx.	770 l	203 gal
CE Certificate		A - 12	
Design		judel / vrolijk & co	
Interior		HanseYachts Design	

Mast length above WL	approx.	25.85 m	84' 10"
Total sail area	approx.	157.00 m <sup>2</sup>	1,690 sq ft
Main sail			
standard	approx.	93.00 m <sup>2</sup>	1,001 sq ft
furling	approx.	82.50 m <sup>2</sup>	888 sq ft
Self-tacking jib	approx.	64.00 m <sup>2</sup>	689 sq ft
Reacher	approx.	115.00 m <sup>2</sup>	1,238 sq ft
Gennaker	approx.	245.00 m <sup>2</sup>	2,637 sq ft

All measurements/figures are approximate. Errors and omissions excepted. All weights are specified in MLC. Specification and material can be changed without notice. Valid for deliveries from 2025.01.01 until 2025.06.30. H588.24.V.2023-12-06.540

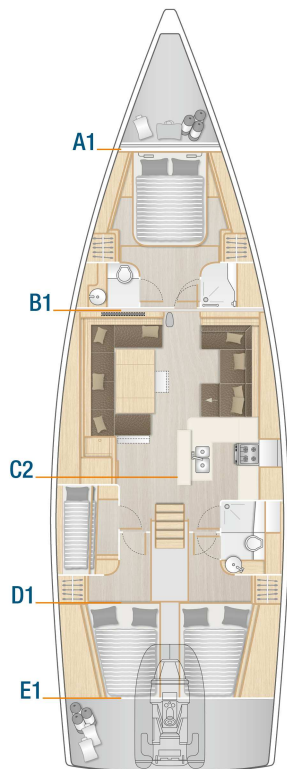

Standard

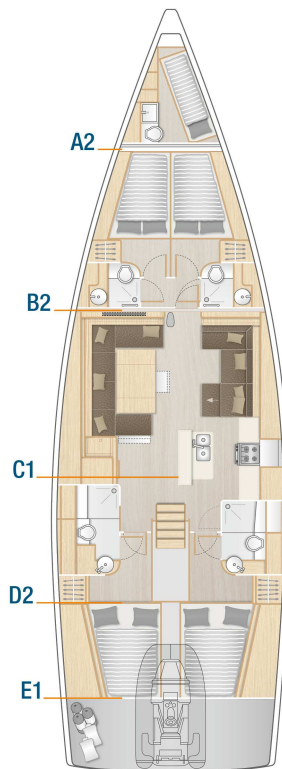

Option

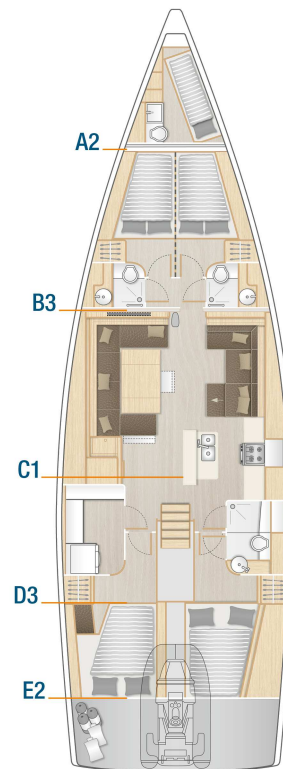

Option

**HULL**

- 12 hull windows (6 each side)
- GRP hull, isophthalic gelcoat, colour: Signal White (similar RAL 9003), 1st layer vinyl ester resin and balsa sandwich laminat
- Waterline and cove line, isophthalic gelcoat, colour: Dark Grey (similar RAL 7043)

**KEEL**

- L-keel, cast iron, draft: 2.60 m
- GRP rudder with sea-water resistant aluminium shaft and selfaligning bearings

**LAYOUT & INTERIOR**

- A1: Sail locker with extensive storage space
- B1: Master cabin with island double berth, storage space and a head with separate shower stall
- C2: Saloon with full functional L-galley and dining area on stb and lounge area with chart table on port
- D1: Cabin with double bunk bed on port with storage space and dayhead door for head in saloon on stb.
- E1: 2 aft cabins with double berth, storage space and separate head
- 3-burner gas stove with oven, ventilation hood, waste bin, 12 V fridge approx. 140 l, double stainless steel sink with mixing tab
- Interior furniture in high quality marine plywood, Satin Varnish
- Hanse companionway closing system
- Saloon table, fixed
- Silent Master Cabin - cabin noise insulation (only with B1 Layout)
- Worktop in galley - 'Marine Mineral Stone' Anthracite

**WOOD (FURNITURE, FLOORBOARD)**

- Furniture - Mahogany Style, Satin Varnish
- Floorboard - Acacia

**UPHOLSTERY**

- Mattresses for all berths
- Upholstery - Monte Carlo, colour: Cream

**DECK & OUTSIDE EQUIPMENT**

- GRP deck with antislip surface, isophthalic gelcoat, colour: Signal White (similar RAL 9003), 1st layer vinyl ester resin with balsa sandwich core. Cockpit locker on stb, dinghy garage, stowage for running rigging at helm position, anchor locker at bow.
  - Synthetic teak on cockpit bottom (colour selection)
  - Synthetic teak on cockpit benches (colour selection)
  - Synthetic teak on bathing platform (colour selection)
  - Twin wheel steering system
  - 2 stainless steel steering wheels with leather cover
  - 2 cockpit tables, stainless steel with teak tops
  - Pulpit and pushpit, stainless steel
  - Railing, incl. stanchions and stainless steel wire with gateway stanchion
  - Covered halyards and control lines lead to cockpit helmposition, organizers and jammers, 4 retractable mooring cleats, handrails on coach roof
  - 2 LEWMAR 65 ST EVO manual halyard winches
  - 2 LEWMAR 55 ST EVO manual secondary winches
  - Bathing platform, hydraulic fold-out, remote control and swimming ladder
  - Anchor windlass, electrical, 1500 W, with automatic fuse and remote control with chain counter
  - Anchor and forestay fitting
  - Self tacking jib system
  - Mainsheet system
  - 12 big and 4 small deck hatches - openable, anchor locker hatch, stowage on coach roof with acrylic glass hatch
  - 6 deck coach roof windows - 4 openable, glass next to companionway, portlights in cockpit side for aft-cabins
- RIG & SAILS**
- Rig, anodized aluminium, keel stepped, with kicker, standing and running rigging and 2 reefs
  - Manual jib furler
  - ELVSTRØM Dacron sails - full battened, main and jib

### NAVIGATION & INSTRUMENTS

- Illuminated compass at each helm
- Navigation lights - LED

### PROPULSION

- Fuel tank, approx. 520 l
- Engine (Diesel, approx. 110 hp) - shaft drive, 3-blade folding propeller

### EQUIPMENT

- 12 V and 230 V electric system with main panels and 230 V shore power and sockets in cabins and heads
- AGM battery set, capacity: 1x 90 Ah + 2x 160 Ah AGM
- Country Version: EU / AUS
- Battery charger 70 A
- Manual toilet with sea water flush - cabin layout B1
- Manual toilet with sea water flush - cabin layout E1 or E2
- Shower unit in cockpit, warm-/coldwater
- LPG gas system, stowage for 2 gas bottles
- Black water system (appr. 35 l per fwd head, appr. 85 l per aft head) with deck extraction and seacock for head, electric and manual bilge pump
- Fresh water system with electric pump and 40 l hotwater, heated also by main engine
- Fresh water tank, appr. 770 l

### ACCESSORIES

- Mast steps

### SHIPPING & TRANSPORT

- CE - Certificate cat. A - 12 / B - 16 / C - 20
- Owners manual
- EC - Type Examination Certificate