



specification
& price list
DS41

| | | |
|--------------------------------|-----------------------|-------------|
| LOA | 12.52 m | 41' 1" |
| LH | 11.99 m | 39' 4" |
| LWL | 11.42 m | 37' 6" |
| Beam | 4.20 m | 13' 9" |
| Draft | 2.14 m | 7' 0" |
| | 1.85 m | 6' 1" |
| Displacement approx. | 11.20 t | 24,692 lbs |
| Ballast approx. | 3.13 t | 6,900 lbs |
| Engine approx. | Diesel 41.9 kW | 57 hp |
| Fresh water | 475 l | 125 gal |
| Fuel tank | 200 l | 53 gal |
| CE Certificate | A - 10 | |
| Mast lenght above DWL | | |
| standard | 19.92 m | 65' 4" |
| furling | 20.17 m | 66' 2" |
| Main approx. | 48.20 m ² | 519 sq ft |
| Jib approx. | 37.60 m ² | 405 sq ft |
| Reaching Yankee | 56.80 m ² | 611 sq ft |
| Gennaker A3 | 117.70 m ² | 1,267 sq ft |
| Total sail area approx. | 85.80 m ² | 924 sq ft |
| Rlg | I 16.8 m | 55' 1" |
| | J 4.7 m | 15' 5" |
| | P 16.2 m | 53' 2" |
| | E 5.5 m | 18' 1" |
| Design | Dixon Yacht Design | |
| Interior | Hanse Design Team | |



deck & interior layouts DS41

Standard



Standard



Standard

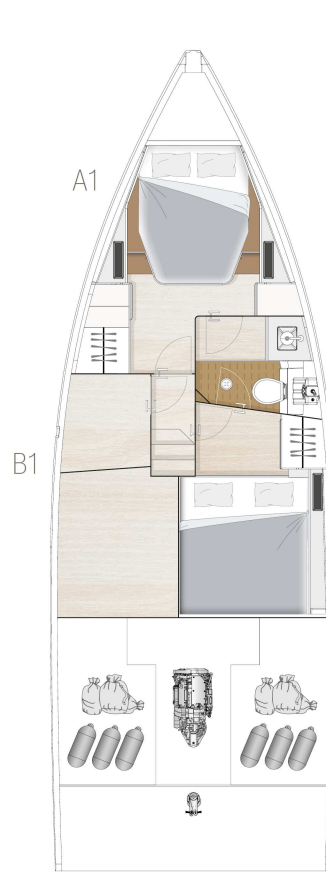

Option

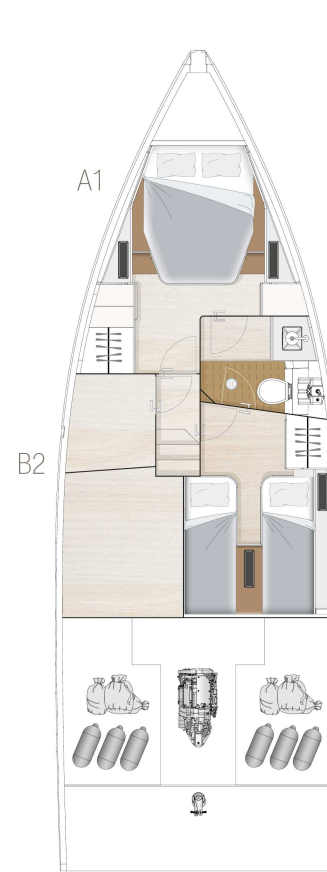

Option

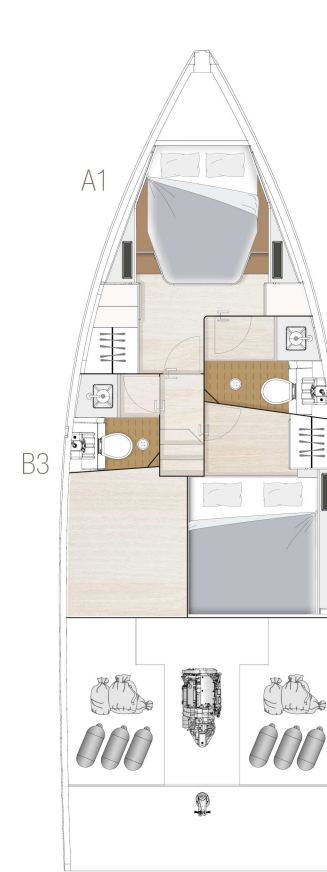

Option

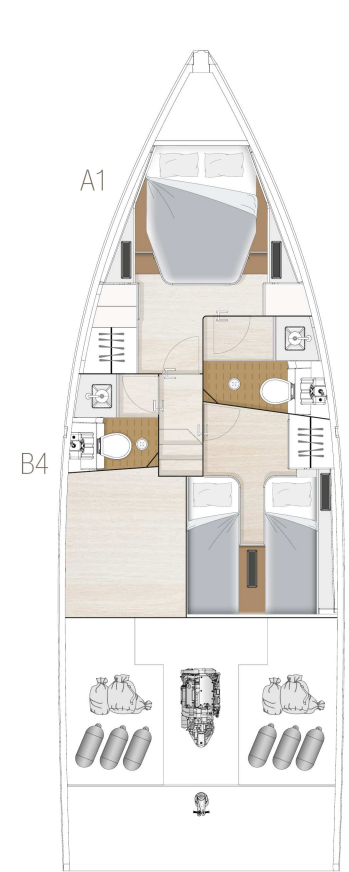

standard specification DS41

HULL

- 4 hull windows (3 on starboard, 1 on port)
- GRP hull, isophthalic gelcoat: Off White (similar RAL 9003), 1st layer vinyl ester resin and balsa sandwich laminat.
- Waterline and cove line, isophthalic gelcoat colour: Moody Grey (similar RAL 7034)

KEEL

- L-keel, cast iron, draft: 2.14 m
- GRP rudder with sea-water resistant aluminium shaft and selfaligning bearings

LAYOUT & INTERIOR

- A1: Master cabin with island double berth, storage space and head with separate shower stall
- B1: Guest cabin with double berth and storage locker
- C1: Saloon with full functional L-galley and dining area on stb - chart table on port and utility area under saloon floorboard
- 3-burner gas stove with oven, waste bin, 12 V fridge approx. 130 l, sink with mixing tab
- Interior furniture in high quality marine plywood, satin varnished
- Sliding door in deckhouse
- Galley, coloured, colour: white
- Worktop in galley - Marine Mineral Stone, colour: Grained Black

WOOD (FURNITURE, FLOORBOARD)

- Furniture - Traditional Mahogany - satin varnish
- Floorboard - New Zealand Acacia

UPHOLSTERY

- Comfort mattresses for all berths
- Upholstery - dorset, colour: Cream

DECK & OUTSIDE EQUIPMENT

- GRP deck with antislip surface, gelcoat colour: Off White (similar RAL 9003), 1st layer vinyl ester resin with balsa sandwich core.
- Synthetic teak on side deck, cockpit bottom, helmsman seats, cockpit benches and bathing platform (colour selection)
- Twin wheel steering system
- 2 stainless steel steering wheels with leather cover
- Cockpit table, stainless steel with folding teak tops
- Pulpit and pushpit, stainless steel
- Railing, stainless steel tube and wire, incl. integrated boarding ladder on both sides
- Halyards and control lines in cockpit at helm position, stern locker, 2 cockpit lockers, 6 retractable mooring cleats, handrail on coach roof, double anchor arm and anchor locker
- 2 LEWMAR 45 EST EVO electrical halyard winches
- Bathing platform, manual fold-out with swimming ladder

- 2 helmsman seats, foldable
- Anchor windlass, electrical, 1500 W, with automatic fuse, remote control with chain counter
- Delta-anchor 25 kg, galvanized with 60 m galvanized chain
- Self tacking jib system
- German mainsheet system
- Foldable window next to patio door at pantry
- Panoramic deckssaloon windows, central glass skylight for deckssaloon with 2 openable hatches, 1 fwd. coach roof front window, 1 coach roof hatch (for head - white opaque glass), 4 mitre-cut portlights at coach roof sides, glass skylight on forward coach roof with a big openable hatch (sz. 70)

RIG & SAILS

- Rig, anodized aluminium, deck stepped, with kicker, standing and running rigging and 2 reefs
- Bimini with sliding mechanism (colour selection)
- QUANTUM Blue Water Dacron sails - full battened, main and jib

NAVIGATION & INSTRUMENTS

- Illuminated compass
- Navigation lights - LED

PROPULSION

- Engine (Diesel, approx. 57 hp) - saildrive, 3-blade folding propeller
- Bowthruster, 12 V, incl. battery - tunnel

EQUIPMENT

- 12 V and 230 V electric system, 230 V shore power and sockets in cabins and heads
- Battery set, capacity: 1x 90 Ah + 2x 160 Ah AGM
- Country Version: EU / AUS
- Battery charger 50 A
- Shore power 230 V or 110 V
- Electric toilet with sea water flush (master cabin)
- Shower unit in cockpit, warm-/coldwater
- LPG gas system, stowage for 1 gas bottle
- Blackwater system (appr. 54 l per head) with deck extraction and seacock for head
- Freshwater system with electric pump and 20 l hotwater, heated also by main engine
- Fresh water tank, appr. 295 l
- Add. fresh water tank, appr. 180 l
- Fuel tank, approx. 200 l

ACCESSORIES

- Blind set with flyscreens for deck hatches
- Skysol blinds for deckshouse windows
- Venetian blinds for hull windows

standard specification DS41

- Wind indicator
- Flagpole
- Add. winch handle
- Mast steps

SHIPPING & TRANSPORT

- CE - Certificate cat. A - 10 / B - 12
- Owners manual
- EC - Type Examination Certificate

standard price list packages DS41

AS PER STANDARD SPECIFICATION

excl. VAT
535.900 €

XW2000 Raymarine Navigation Package 15.900 €

| | |
|--------|---|
| XF2210 | 2 Raymarine i70s multifunction displays at helm position, incl. transducer (speed/wind/depth/temperature) |
| XF3000 | Raymarine VHF RAY90 at chart table, incl. handset |
| XF4010 | 2 Raymarine Axiom 9" GPS chart plotter, one per helm position |
| XF4600 | AIS Class B transponder |
| XF5000 | Raymarine Evolution Autopilot with p70Rs display and S100 remote control at helm position, port |
| XF9001 | NMEA Engine information interface for chart plotter |
| XK5000 | VHF preparation with antenna and splitter for FM and AIS |

XW2001 Upgrade - Axiom Pro 2.350 €

| | |
|--------|---|
| XF4011 | 2 Raymarine Axiom Pro 9" GPS chart plotter, one per helm position |
|--------|---|

XW2005 Upgrade - 3rd Helmsmanstation at chart table 3.550 €

| | |
|--------|--|
| XF5110 | Raymarine p70Rs Autopilot display at chart table |
| XG2101 | Add. electronic throttle control at chart table |

XW6500 Smart Connection Package 3.450 €

| | |
|--------|-----------------------------------|
| XF4655 | Interior camera |
| XK5031 | WLAN router incl. booster antenna |

XW7000 Entertainment Package - Saloon 3.650 €

| | |
|--------|--|
| XK1000 | FUSION APOLLO MS-RA770 Multimedia radio with Wi-Fi and touchscreen - for saloon and cockpit (only with XK5000) |
|--------|--|

| | |
|--------|---|
| XK2000 | 2 high-end 2-way speakers in saloon and cockpit |
| XK3070 | FUSION MS-ERX400 remote control in cockpit |

XW7010 Entertainment Package - Master cabin 2.350 €

| | |
|--------|--|
| XK1010 | FUSION APOLLO MS-RA770 Multimedia radio with Wi-Fi and touchscreen - for master cabin (only with XK5000) |
| XK2010 | 2 high-end 2-way speakers in master cabin |

XW7030 TV Package - Saloon 1.700 €

| | |
|--------|------------------------------------|
| XK4040 | TV preparation in saloon |
| XK4140 | LED TV flat screen in saloon |
| XK4240 | Manual TV folding system in saloon |

standard price list options DS41

| | | excl. VAT | | | |
|-------------------------------------|--|-----------|-------------------------------------|---|---------|
| HULL | | | UPHOLSTERY | | |
| XA1001 | GRP hull, coloured gelcoat (colour selection) | 4.500 € | XN2001 | Upholstery - oxford (colour selection) | 1.100 € |
| XA1002 | GRP hull, painted, non metallic (colour selection) | 21.400 € | XN2002 | Upholstery - devon (colour selection) | 1.700 € |
| XA1003 | GRP hull, painted, metallic (colour selection) | 27.850 € | XN2003 | Upholstery - orkney (colour selection) | 2.050 € |
| XA3001 | Waterline and cove line, coloured gelcoat (colour selection - only with XA1000 or XA1001) | 800 € | XN2004 | Upholstery - yorkshire leather (colour selection) | 5.100 € |
| XA3002 | Waterline and cove line, painted, non metallic (colour selection - only with XA1002 or XA1003) | 900 € | XN2200 | Sun bed cushions on foredeck (colour selection) | 2.350 € |
| XA3003 | Waterline and cove line, painted, metallic (colour selection - only with XA1002 or XA1003) | 1.900 € | XN2501 | Cockpit cushions with backrest (colour selection) | 3.150 € |
| KEEL | | | XN4001 | Curtains for saloon sliding door (colour selection) | 1.100 € |
| XB1001 | L-keel, cast iron, draft: 1.85 m | 9.150 € | DECK & OUTSIDE EQUIPMENT | | |
| XB9000 | Keel and rudder - not mounted | 1.000 € | XC1360 | Real teak on side deck, cockpit bottom, helmsman seats, cockpit benches and bathing platform | 3.050 € |
| LAYOUT & INTERIOR | | | XC2201 | 2 GRP steering wheels, Y-spoke (black or white) | 1.850 € |
| XL2002 | B2: Guest cabin with two single berth and storage locker | 700 € | XC5200 | 2 LEWMAR 45 ST EVO manual secondary winches, on stainless steel pedestal | 3.050 € |
| XL2003 | B3: Guest cabin with double berth and guest head with shower | 4.500 € | XC6001 | Bathing platform, manual fold-out with swimming stairs | 2.550 € |
| XL2004 | B4: Guest cabin with two single berth and guest head with shower | 5.200 € | XC6005 | Automatic fold-out for bathing platform with remote control | 2.550 € |
| XL6202 | Galley, coloured, colour: dark grey | 1.200 € | XC6210 | Watertight storage room, aft | 2.650 € |
| XL7001 | Saloon table electrically lowerable with cushions, convertible into double berth | 2.950 € | XC7200 | Davits for dinghi | 2.950 € |
| XL7601 | Worktop in galley - Marine Mineral Stone (colour selection) | 800 € | XC9020 | Rub rail, teak | 2.750 € |
| WOOD (FURNITURE, FLOORBOARD) | | | XC9021 | Additional stainless steel rail (only with XC9020) | 2.050 € |
| XM1102 | Furniture - Teak | 8.550 € | XC9050 | Electrical deck wash pump inside anchor locker | 1.200 € |
| XM1104 | Furniture - Golden Oak | 8.550 € | XC9101 | Delta-anchor 25 kg, stainless steel, with 'Power Ball' swivel and 100 m stainless steel chain | 4.400 € |
| XM1150 | Furniture - High Gloss Finish (only with XM1100) | 10.400 € | XC9201 | Genoa tracks (not with XE1220 or XE1221) | 1.200 € |
| | | | XC9423 | Fixed window next to patio door at pantry | 0 € |

standard price list options DS41

RIG & SAILS

| | | |
|--------|---|----------|
| XE1001 | Rig, anodized aluminium with manual inmast furling system | 4.250 € |
| XE1010 | Rig, anodized aluminium with electric inmast furling system | 10.500 € |
| XE1210 | Electric jib furler | 11.700 € |
| XE1220 | Second forestay with furler, manual and genoa tracks with pin stop (only with XC5200) | 6.950 € |
| XE1221 | Second forestay with furler, electrical and genoa tracks with pin stop | 12.950 € |
| XE2001 | Lazy-bag with lazy jacks (colour selection - not with XE1001 or XE1010) | 1.300 € |
| XE3005 | QUANTUM AC5 performance sails - full battened, triradial, main and jib | 7.650 € |
| XE3010 | QUANTUM TP6 high-performance sails - full battened, UV-protected membrane, main and jib | 14.050 € |
| XE3024 | QUANTUM AC5 Genoa 135% (only with XE1220 or XE1221) | 8.150 € |
| XE3025 | QUANTUM TP6 Genoa 135%, with UV protection (only with XE1220 or XE1221) | 13.950 € |
| XE3105 | QUANTUM Gennaker incl. squeezer (colour selection) | 4.250 € |
| XE9004 | Gennaker package incl. halyard, 2 sheets, 2 blocks and padeyes | 1.700 € |
| XE9100 | Spreader lights, LED, 4 up and 4 down | 3.450 € |

NAVIGATION & INSTRUMENTS

| | | |
|--------|---|----------|
| XF4000 | Raymarine Axiom Pro 12" GPS chart plotter at chart table | 5.500 € |
| XF4500 | Raymarine Quantum 2 Radar, on first spreader | 4.150 € |
| XF4560 | MyMoody Safety Cloud hardware with 30 days free trial subscription and an interior light, switchable by APP | 1.500 € |
| XF4650 | Thermal vision camera at mast (only with Navigation Package) | 6.500 € |
| XF4653 | SEA.AI Offshore ONE (only with Navigation Package) | 11.800 € |

PROPULSION

| | | |
|--------|---|---------|
| XG1103 | Engine (Diesel, approx. 80 hp) - saildrive, 3-blade folding propeller | 6.950 € |
| XG1810 | Add. electronic throttle control and thruster control at helm position, on port | 3.450 € |

| | | |
|--------|---|----------|
| XG3201 | Sternthruster, 12 V, retractable, incl. battery | 14.250 € |
|--------|---|----------|

EQUIPMENT

| | | |
|--------|---|----------|
| XH1001 | Battery set, capacity upgraded to: 1x 90 Ah + 4x 160 Ah AGM | 1.100 € |
| XH1110 | Deep charge protection for service batteries | 1.400 € |
| XH1601 | Country Version: US / JPN | 3.550 € |
| XH2101 | Generator 8000i, 6,4 kW / 0 - 7,2 kVA, incl. maintenance kit (MPL housing) | 19.900 € |
| XH2201 | Inverter/charger, 12 V / 2600 W - 100 A, incl. AC panel (only with XH1001) | 4.050 € |
| XH3011 | Electric toilet with sea water flush (guest cabin) | 1.950 € |
| XH3200 | Freshwater dockside connection in transom | 600 € |
| XH4011 | Heating, hot air with blowers in cabins and heads | 8.050 € |
| XH4510 | Air conditioning, 24.000 BTU, 2 units: saloon and master cabin, incl. 2nd shore power | 19.550 € |
| XH4511 | Air conditioning, 8.000 BTU, 1 unit: guest cabin (only with XH4510) | 7.150 € |
| XH5100 | Add. fridge in storage under saloon floorboard | 2.000 € |
| XH5150 | Microwave in saloon | 1.600 € |
| XH5210 | Dishwasher in saloon | 2.450 € |
| XH5311 | Washing machine with dryer function, front opening in saloon stowage | 3.550 € |
| XH5409 | Gas leak detector | 1.000 € |
| XH5610 | Grey-water system "Lakes" for bathrooms and galley, tank: 100 l - no hull-through fittings for grey and black water, fresh-water capacity reduced | 1.700 € |
| XH6001 | Grey-water system for bathrooms and galley, tank: 100 l - fresh-water capacity reduced | 1.950 € |
| XH6020 | Add. fuel tank, appr. 200 l (only with XH2101) | 3.550 € |

RADIO & ENTERTAINMENT

| | | |
|--------|--|-------|
| XK5000 | VHF preparation with antenna and splitter for FM and AIS | 600 € |
|--------|--|-------|

standard price list options DS41

ACCESSORIES

| | | |
|--------|---|---------|
| XV9045 | External sunshade for deckshouse windows (colour selection) | 2.750 € |
| XV9120 | Cover for cockpit table (colour selection) | 700 € |
| XV9130 | Cover for steering wheels (colour selection) | 700 € |
| XV9380 | Shrink wrap foil (for storage purpose only / not for transport) (not with XA1002, XA1003, XA3002, XA3003) | 800 € |
| XV9901 | 6 fenders | 500 € |
| XV9902 | 4 mooring lines, plaited | 400 € |

SHIPPING & TRANSPORT

| | | |
|--------|--------------------------------|---------|
| XZ2001 | Loading on truck | 700 € |
| XZ2003 | Oversea shipping pack (cradle) | 3.450 € |
| XZ2020 | Ready for Pickup | 700 € |

All mentioned prices in €, basic prices ex yard and excl. VAT. All weights and measures are calculated numbers based on the construction data. Changes in construction and equipment reserved. Above mentioned prices are recommended for ex yard deliveries within 4 month after order confirmation. For later delivery time the company reserves right to apply latest price list. Company reserves additional 15 working days when painted hull or deck is ordered. All measurements/figures are approximate. Errors and omissions excepted. Specification and material can be changed without notice. Valid for deliveries from 2025.01.01 until 2025.06.30. M16A.24.V.2023-07-26.106