

# PRICELIST & SPECIFICATION



LOA	approx.	11.32 m	37' 2"
Hull length	approx.	10.60 m	34' 9"
LWL	approx.	10.29 m	33' 9"
Beam	approx.	3.99 m	13' 1"
Draft			
shallow keel	approx.	1.65 m	5' 5"
L-keel, medium	approx.	2.05 m	6' 9"
Displacement			
shallow keel	approx.	8.01 t	17,659 lbs
L-keel, medium	approx.	7.80 t	17,196 lbs
Engine			
Diesel-standard	approx.	29.00 PS	29.00 hp
Diesel-option	approx.	39.00 PS	39.00 hp
Electric 18kW/h	approx.	25 kW	25 kW
Electric 36kW/h	approx.	25 kW	25 kW
Fuel tank	approx.	160 l	42 gal
Fresh water	approx.	345 l	91 gal
CE Certificate	A-6		
Design	Berret - Racoupeau		
Interior	Berret - Racoupeau		

Mast length above WL	approx.	16,75 m	54' 11"
Total sail area	approx.	61 m <sup>2</sup>	656,60 sq ft
Main sail			
standard	approx.	35 m <sup>2</sup>	365,97 sq ft
performance	approx.	40 m <sup>2</sup>	430,55 sq ft
furling	approx.	33 m <sup>2</sup>	355,21 sq ft
Self-tacking jib	approx.	26 m <sup>2</sup>	279,86 sq ft
Genoa	approx.	32 m <sup>2</sup>	344,44 sq ft
Crossover	approx.	68 m <sup>2</sup>	731,94 sq ft
Gennaker	approx.	103 m <sup>2</sup>	1108,68 sq ft

All measurements/figures are approximate. Errors and omissions excepted. All weights are specified in MLC. Specification and material can be changed without notice. Valid from 2024.06.27 for deliveries until 2025.06.30. H22B.25.V.2024-06-26.1062

# 360

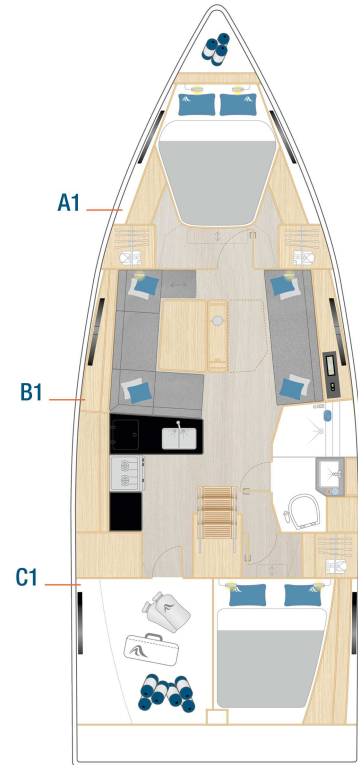
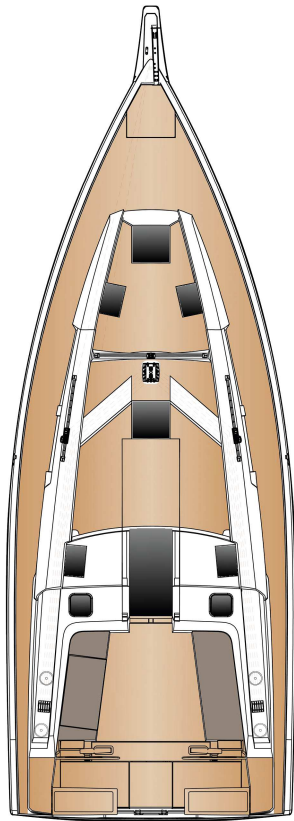

Standard

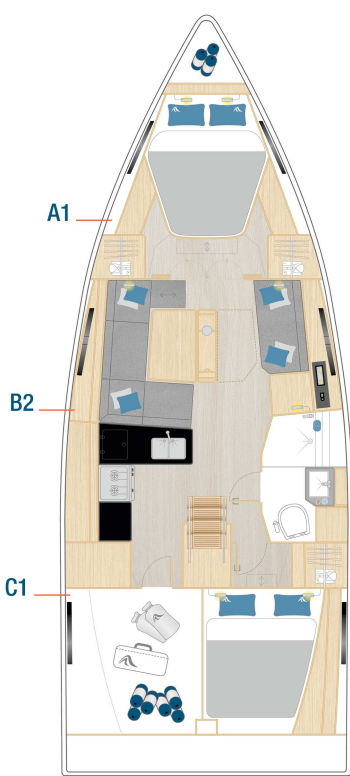

Option

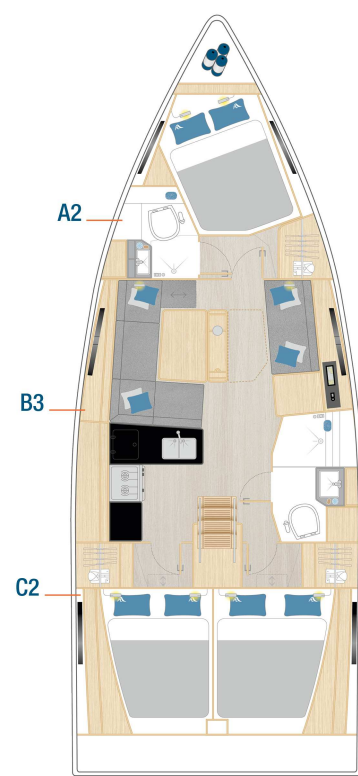

Option

## HULL

- 6 hull windows (3 each side)
- GRP hull, isophthalic gelcoat, colour: Signal White (similar RAL 9003), 1st layer vinyl ester resin and balsa sandwich laminat
- Waterline, isophthalic gelcoat, colour: Dark Grey (similar RAL 7043)

## KEEL

- L-keel, cast iron, draft: 2.05 m
- GRP rudder with sea-water resistant aluminium shaft and selfaligning bearings

## LAYOUT & INTERIOR

- A1: Master cabin with island double berth and storage space
- B1: Saloon with large dining area on port and sofa on stb
- C1: Large L-galley and storage space on port. Head with separate shower stall, aft cabin with double berth, locker and storage on stb.
- 2-burner gas stove with oven, waste bin, 12 V fridge approx. 135 l, double stainless steel sink with mixing tab
- Interior furniture in high quality marine plywood, Satin Varnish
- Hanse companionway closing system
- Saloon table, fixed with integrated storage
- Worktop in galley and heads - Black Quartz

## WOOD (FURNITURE, FLOORBOARD)

- Furniture - Mahogany Style, Satin Varnish
- Floorboard - Acacia

## UPHOLSTERY

- Mattresses for all berths
- Upholstery - Monte Carlo, colour: Cream

## DECK & OUTSIDE EQUIPMENT

- GRP deck with antislip surface, isophthalic gelcoat, colour: Signal White (similar RAL 9003), 1st layer vinyl ester resin with balsa sandwich core. 1 cockpit locker, 1 space for life raft, stern locker, stowage for running rigging at helm position, anchor locker at bow.
- Twin wheel steering system with emergency tiller
- 2 stainless steel steering wheels with leather cover
- Pulpit and pushpit, stainless steel
- Railing, incl. stanchions and stainless steel wire
- Covered halyards and control lines lead to cockpit helmposition, organizers and jammers, 4 mooring cleats, handrails on coach roof

- 2 LEWMAR 40 ST EVO manual halyard winches
- Swimming ladder
- Bow fitting with anchor roller
- Self tacking jib system
- Mainsheet system
- 2 large and 6 small deck hatches - openable, anchor locker hatch
- 4 large coach roof side windows - openable, 3 portlights in coach roof

## RIG & SAILS

- Rig, anodized aluminium, deck stepped, with kicker, standing and running rigging and 2 reefs
- Manual jib furler
- ELVSTRØM Dacron sails - full battened, main and jib

## NAVIGATION & INSTRUMENTS

- Navigation lights - LED

## PROPULSION

- Fuel tank, approx. 160 l
- Engine (Diesel, approx. 29 hp) - saildrive, 2-blade fix propeller

## EQUIPMENT

- 12 V and 230 V electric system with main panels and 230 V shore power and sockets in cabins and heads
- AGM battery set, capacity: 1x 90 Ah + 1x 160 Ah AGM
- Country Version: EU / AUS
- Battery charger
- Manual toilet with sea water flush - cabin layout C
- LPG gas system, stowage for 1 gas bottle
- Black water system (appr. 54 l each bathroom) with deck extraction and seacock for head, electric and manual bilge pump
- Fresh water system with electric pump and 20 l hot water, heated also by main engine
- Fresh water tank, appr. 345 l

## SHIPPING & TRANSPORT

- CE - Certificate cat. A - 6
- Owners manual
- EC - Type Examination Certificate

## AS PER STANDARD SPECIFICATION

excl. VAT  
185.900 €

## PACKAGES

<b>XW2000</b>	<b>Raymarine Navigation Package (only with XC3001 or XC3003)</b>	<b>5.550 €</b>
XF2200	2 Raymarine i70s multifunction displays in cockpit, incl. transducer (wind/depth/speed/temperature)	
XF4010	Raymarine AXIOM PRO 9 S chart plotter with HybridTouch multifunction display at cockpit table	
<hr/>		
<b>XW2001</b>	<b>Upgrade - 12" chart plotter (only with XC3003)</b>	<b>1.350 €</b>
XF4011	Raymarine AXIOM PRO 12 S chart plotter with HybridTouch multifunction display at cockpit table	
<hr/>		
<b>XW2002</b>	<b>Upgrade - Navigation Package</b>	<b>6.200 €</b>
XF3000	Raymarine VHF Ray63 in saloon, incl. wireless remote handset (only with XK5000)	
XF5000	Raymarine Evolution Autopilot with p70s display and wireless remote control	
XK5000	VHF preparation with antenna and splitter for FM and AIS	
<hr/>		
<b>XW3000</b>	<b>Cruising Package</b>	<b>16.100 €</b>
XC1326	Synthetic teak on cockpit bottom (colour selection)	
XC1334	Synthetic teak on helmsman seats (colour selection)	
XC1341	Synthetic teak on cockpit benches (colour selection)	
XC1351	Synthetic teak on bathing platform (colour selection)	
XC3001	Cockpit table, stainless steel with folding teak tops	
XC6001	Bathing platform, manual fold-out with swimming ladder	
XC9060	2 helmsman seats, foldable	
XC9062	Helmsman footrests (free mountable)	
XC9080	2 additional cleats, midship (1 each side)	
XC9090	Anchor windlass, electrical, with automatic fuse and remote control with chain counter	
XC9100	Delta-anchor 16 kg, galvanized with 30 m galvanized chain	
XH1001	Battery set, capacity: 1x 90 Ah + 2x 160 Ah AGM	
XH3110	Shower unit in cockpit, warm-/coldwater	
XH5030	Water akku for pressure equalization	
XV9420	Wind indicator	
XV9450	Flagpole	
XV9901	6 fenders	

XV9902	4 mooring lines
XV9910	Add. winch handle
XV9920	Mast steps
XV9950	Hanse maintenance kit

---

<b>XW3001</b>	<b>Upgrade - Real teak</b>	<b>1.650 €</b>
---------------	----------------------------	----------------

XC1325	Real teak on cockpit bottom
XC1333	Real teak on helmsman seats
XC1340	Real teak on cockpit benches
XC1350	Real teak on bathing platform

---

<b>XW3002</b>	<b>Upgrade - stainless steel anchor with chain</b>	<b>3.850 €</b>
---------------	----------------------------------------------------	----------------

XC9101	Delta-anchor 16 kg, stainless steel, with 'Power Ball' swivel and 50 m stainless steel chain
--------	----------------------------------------------------------------------------------------------

---

<b>XW3003</b>	<b>Upgrade - cockpit table with stowage and fridge</b>	<b>2.550 €</b>
---------------	--------------------------------------------------------	----------------

XC3003	Cockpit table with stowage and fridge
--------	---------------------------------------

---

<b>XW3004</b>	<b>Upgrade - Battery set Lithium</b>	<b>7.350 €</b>
---------------	--------------------------------------	----------------

XH1005	Battery set, capacity: 1x 90 Ah + 2x 200 Ah Lithium
--------	-----------------------------------------------------

---

<b>XW4000</b>	<b>Performance Package</b>	<b>7.200 €</b>
---------------	----------------------------	----------------

XC2201	2 GRP steering wheels, Y-spoke (black or white)
XE3005	ELVSTRØM SPS performance sails - full battened, triradial main and jib
XE9001	Dyneema halyards for main and jib
XE9002	Mainsail slider system

---

<b>XW4001</b>	<b>Upgrade - Secondary Winches</b>	<b>2.300 €</b>
---------------	------------------------------------	----------------

XC5200	2 LEWMAR 40 ST EVO manual secondary winches
--------	---------------------------------------------

---

<b>XW4100</b>	<b>Gennaker Package</b>	<b>5.900 €</b>
---------------	-------------------------	----------------

XE3100	ELVSTRØM Gennaker (colour selection - only with XC9170)
XE3110	Squeezer for Gennaker
XE9003	Gennaker package incl. halyard, 2 sheets, 2 blocks and padeye (only with XC9170) (not with XE9004)

---

**XW5000 Comfort Package 4.950 €**

- XC9032 Courtesy lights in cockpit
- XC9033 Courtesy lights at companionway
- XC9040 Exterior Light Signature
- XC9300 Vent for coach roof hatch
- XL9003 Indirect lights in saloon and cabins
- XL9004 LED overhead lights in saloon and master cabin
- XN2500 Cockpit cushions (colour selection)
- XV9010 Blind set with flyscreens for deck hatches
- XV9060 Blinds for hull windows
- XV9080 Blinds for side coach roof windows

**XW6000 Flagship Package 4.900 €**

- XL7235 Headboards for all cabins
- XL7410 Leather covered handrails
- XL9002 Reading lights at the the main bulkhead
- XN2055 Luxury upholstery in saloon

**XW6500 Smart Connection Package 3.550 €**

- XF4655 Interior camera
- XK5031 WLAN router incl. booster antenna

**XW7000 Entertainment Package 2.200 €**

- XH2090 Wireless charging in saloon
- XK1000 FUSION MS-RA70N Multimedia radio with bluetooth - for saloon and cockpit (only with XK5000)
- XK2000 2x 2 speakers in saloon and cockpit
- XK3070 FUSION MS-NRX remote control in cockpit

**XW7001 Upgrade - Premium Radio 1.050 €**

- XK1001 FUSION APOLLO MS-RA770 Multimedia radio with Wi-Fi and touchscreen - for saloon and cockpit (only with XK5000)
- XK3071 FUSION MS-ERX400 remote control in cockpit
- XK5030 FUSION wireless link - remote control via mobile devices

<b>XW7030</b>	<b>TV Package - Saloon</b>	<b>1.750 €</b>
XK4040	TV preparation in saloon	
XK4100	LED TV flat screen in saloon	
XK5020	DVB-T2 antenna for TV	

## OPTIONS

excl. VAT

### HULL

XA1001	GRP hull, gelcoat colour: Grey (similar RAL 7040)	<b>3.850 €</b>
XA3001	Waterline, coloured gelcoat (colour selection)	<b>600 €</b>

### KEEL

XB1001	L-keel, cast iron, draft: 1.65 m	<b>3.650 €</b>
XB9000	Keel and rudder - not mounted	<b>800 €</b>

### LAYOUT & INTERIOR

XL1002	A2: Master cabin with double berth, storage space and separate head	<b>5.500 €</b>
XL2002	B2: Saloon with large dining area on port and sofa with chart table on stb	<b>1.150 €</b>
XL2003	B3: Saloon with large dining area on port and sofa with multi function unit, navigation console and storage on stb	<b>1.550 €</b>
XL3002	C2: L-galley on port and head with separate shower stall on stb. 2 aft cabins with double berth, locker and storage.	<b>2.800 €</b>
XL6051	Double door in main bulkhead (only with A1 layout)	<b>2.700 €</b>
XL7001	Saloon table, foldable with integrated bar	<b>1.450 €</b>
XL7201	Seating area in saloon convertible into double berth (only with XL7001)	<b>1.450 €</b>
XL7601	Worktop in galley and heads - Off White	<b>700 €</b>

### WOOD (FURNITURE, FLOORBOARD)

XM1102	Furniture - Teak	<b>3.850 €</b>
XM1103	Furniture - Canadian Chestnut	<b>3.850 €</b>
XM1104	Furniture - French Oak	<b>3.850 €</b>
XM1201	Floorboard - Classic Stripes	<b>1.900 €</b>
XM1202	Floorboard - Noce Nero	<b>800 €</b>
XM1203	Floorboard - Delight Oak	<b>800 €</b>



## UPHOLSTERY

XN2001	Upholstery - Sorrento (colour selection)	800 €
XN2002	Upholstery - Florence (colour selection)	1.300 €
XN2003	Upholstery - Monaco (colour selection)	1.700 €
XN2004	Upholstery - Portofino Leather (colour selection)	3.500 €
XN2400	Sun bed cushions on coach roof (colour selection)	1.200 €
XN2500	Cockpit cushions (colour selection)	1.400 €
XN2503	Cushion for helmsman seats (colour selection - only with XC9060)	600 €
XN2506	Cushion for BBQ box (colour selection - only with XH5140)	400 €

## DECK & OUTSIDE EQUIPMENT

XC1300	Real teak on side deck	12.250 €
XC1301	Synthetic teak on side deck (colour selection)	11.850 €
XC1310	Real teak on coach roof	5.700 €
XC1311	Synthetic teak on coach roof (colour selection)	5.300 €
XC2201	2 GRP steering wheels, Y-spoke (black or white)	1.900 €
XC4001	Gateway stanchion	1.050 €
XC5102	2 LEWMAR 45 EST EVO electrical halyard winches with automatic fuse (only with XH1001 or XH1005)	7.500 €
XC5200	2 LEWMAR 40 ST EVO manual secondary winches	2.700 €
XC9020	Rub rail, teak	1.500 €
XC9170	Composite bowsprit with integrated anchor and forestay fitting with mooring roll incl. Crossover and Gennaker tack point	1.600 €
XC9200	Genoa tracks incl. cars with pin stop	2.200 €

## RIG & SAILS

XE1001	Mast, anodized aluminium with manual inmast furling system	3.000 €
XE2001	Lazy bag with lazy jacks (colour selection - not with XE1001)	1.200 €
XE2012	Sprayhood with stainless steel stake, 3 windows (1 openable - colour selection)	2.900 €
XE2021	Bimini with stainless steel stake (colour selection)	3.650 €
XE3005	ELVSTRØM SPS performance sails - full battened, triradial main and jib	5.300 €
XE3006	ELVSTRØM SPS performance sails - full battened, triradial, square top main and jib (without backstay) (not with XE1001)	6.000 €
XE3300	ELVSTRØM CZ Crossover sail - with CX endless furler and storage bag (only with XC9170)	6.200 €
XE9001	Dyneema halyards for main and jib	1.100 €



XE9003	Gennaker package incl. halyard, 2 sheets, 2 blocks and padeye (only with XC9170) (not with XE9004)	<b>1.100 €</b>
XE9004	Crossover package incl. 2:1 halyard, 2 sheets, 2 blocks and padeye (only with XC9170) (not with XE9003)	<b>1.300 €</b>

## NAVIGATION & INSTRUMENTS

XF4600	Raymarine AIS Class B transponder (only with chart plotter and XK5000)	<b>1.650 €</b>
--------	------------------------------------------------------------------------	----------------

## PROPULSION

XG1001	Engine (Diesel, approx. 29 hp) - saildrive, 2-blade folding propeller	<b>1.750 €</b>
XG1101	Engine (Diesel, approx. 39 hp) - saildrive, 2-blade folding propeller	<b>4.950 €</b>
XG1500	Electric propulsion (approx. 25kW / 18,4kWh battery) - saildrive, 3-blade folding propeller (only with XW2001)	<b>42.000 €</b>
XG1510	Electric propulsion (approx. 25kW / 36,7kWh battery) - saildrive, 3-blade folding propeller (only with XW2001)	<b>63.050 €</b>
XG3101	Bowthruster, 12 V, retractable, incl. battery	<b>9.550 €</b>
XG3201	Sternthruster, 12 V, retractable, incl. battery (only with XG3101 and XW2001)	<b>13.650 €</b>

## EQUIPMENT

XH1601	Country Version: US / JPN	<b>1.800 €</b>
XH2080	Solar panel on coach roof	<b>5.800 €</b>
XH2085	Fuel Cell Pro 2800 BT max. 125 W	<b>10.400 €</b>
XH2201	Inverter/charger, incl. larger AC panel (only with XH1001 or XH1005)	<b>2.950 €</b>
XH3001	Electric toilet with sea water flush - cabin layout C	<b>1.450 €</b>
XH3011	Electric toilet with sea water flush - cabin layout A2	<b>1.450 €</b>
XH4011	Heating, hot air with blowers in saloon, heads and master cabin	<b>4.650 €</b>
XH4021	Outlet for heating in aft cabin stb (only with XH4011 and layout C1)	<b>500 €</b>
XH4022	Outlet for heating in aft cabins (only with XH4011 and layout C2)	<b>700 €</b>
XH4511	Air conditioning, 12.000 BTU, 1 unit: saloon and master cabin, incl. 2nd shore power	<b>11.750 €</b>
XH4514	Air conditioning, 8.000 BTU, 1 unit: aft cabin (only with XH4511)	<b>7.350 €</b>
XH5100	Additional drawer fridge/freezer combination in multifunction unit (only with XH1001 or XH1005 and layout B3)	<b>2.300 €</b>
XH5101	Additional drawer fridge/freezer combination in galley (only with XH1001 or XH1005 and layout C1)	<b>2.300 €</b>
XH5140	BBQ box with additional seat in cockpit	<b>4.500 €</b>
XH5150	Microwave in galley	<b>1.600 €</b>
XH5409	Gas leak detector	<b>1.050 €</b>
XH5610	Grey water system "Lakes" for bathrooms and galley, tank: 79 l - no hull-through fittings for grey and black water	<b>2.650 €</b>
XH6001	Grey water system for bathrooms and galley, tank: 79 l	<b>2.850 €</b>

## RADIO & ENTERTAINMENT

XK5000	VHF preparation with antenna and splitter for FM and AIS	750 €
--------	----------------------------------------------------------	-------

---

## ACCESSORIES

XV9120	Cover for cockpit table (colour selection)	550 €
XV9130	Cover for steering wheels (colour selection)	550 €

---

## SHIPPING & TRANSPORT

XZ2001	Loading on truck	600 €
XZ2003	Oversea shipping pack (cradle)	3.550 €
XZ2020	Ready for Pickup	700 €

All mentioned prices in €, basic prices ex yard and excl. VAT. All weights and measures are calculated numbers based on the construction data. Changes in construction and equipment reserved. Above mentioned prices are recommended for ex yard deliveries within 4 month after order confirmation. For later delivery time the company reserves right to apply latest price list. Company reserves additional 15 working days when painted hull or deck is ordered. All measurements/figures are approximate. Errors and omissions excepted. Specification and material can be changed without notice. Valid from 2024.06.27 for deliveries until 2025.06.30. H22B.25.V.2024-06-26.1062